

# FIXED SLEEPER SYSTEM - SIDE VIEW

HORNER FLOORING COMPANY  
DOLLAR BAY, MI  
11-01-09

SLAB DEPRESSION	
25/32" (20mm)	33/32" (26mm)
3-1/8" (79mm)	3-3/8" (86mm)

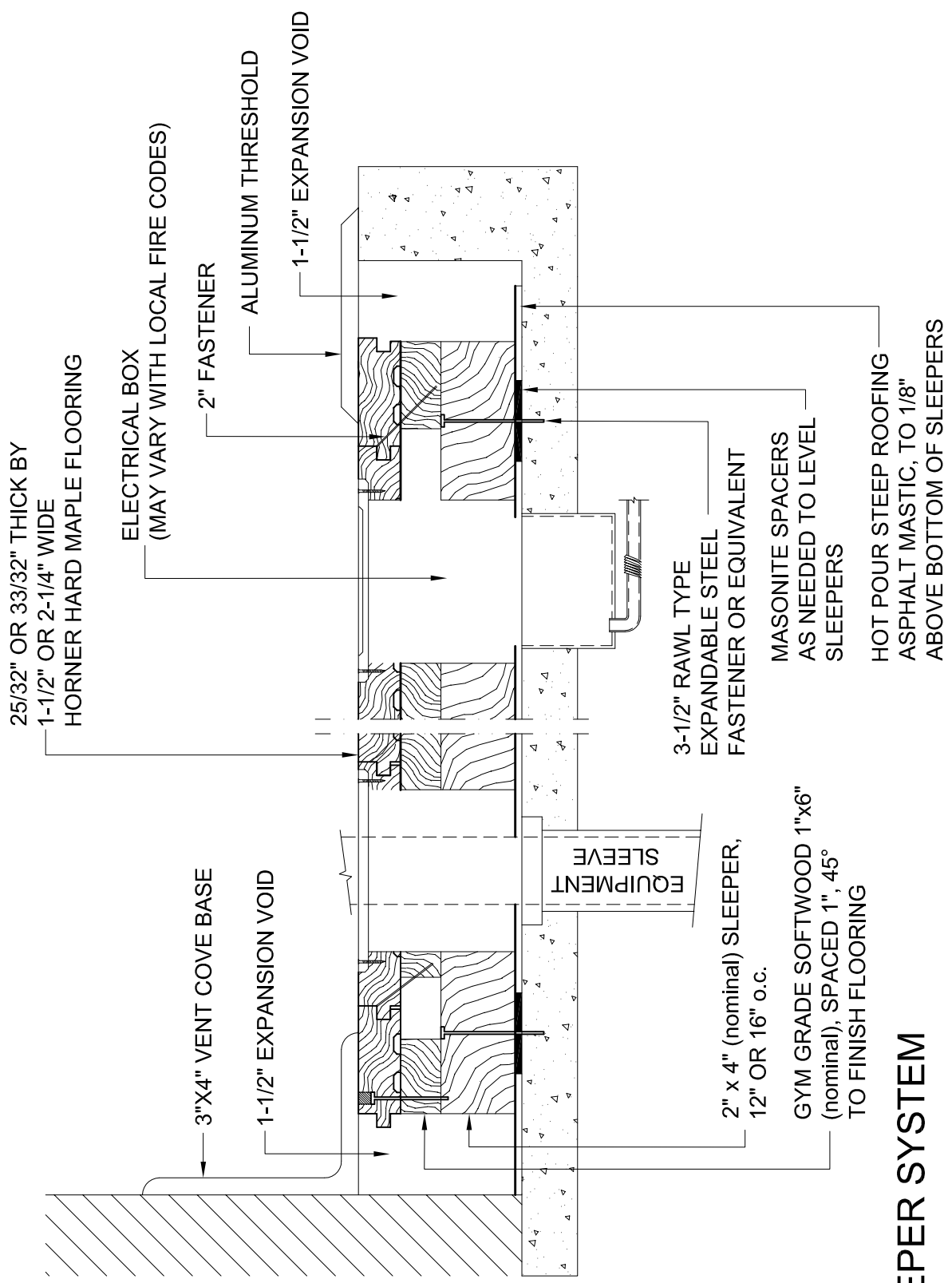

# FIXED SLEEPER SYSTEM

HORNER FLOORING COMPANY  
 DOLLAR BAY, MI  
 11-01-09