

BALANCED PERFORMANCE SYSTEM (BPS) - LOW PROFILE SIDE VIEW

HORNER FLOORING COMPANY
DOLLAR BAY, MI
3-25-11

SLAB DEPRESSION			
	FLOORING	25/32" (20mm)	33/32" (26mm)
LOW PROFILE	1/4" FOAM (11mm)	1-13/16" (46mm)	2-1/16" (52mm)

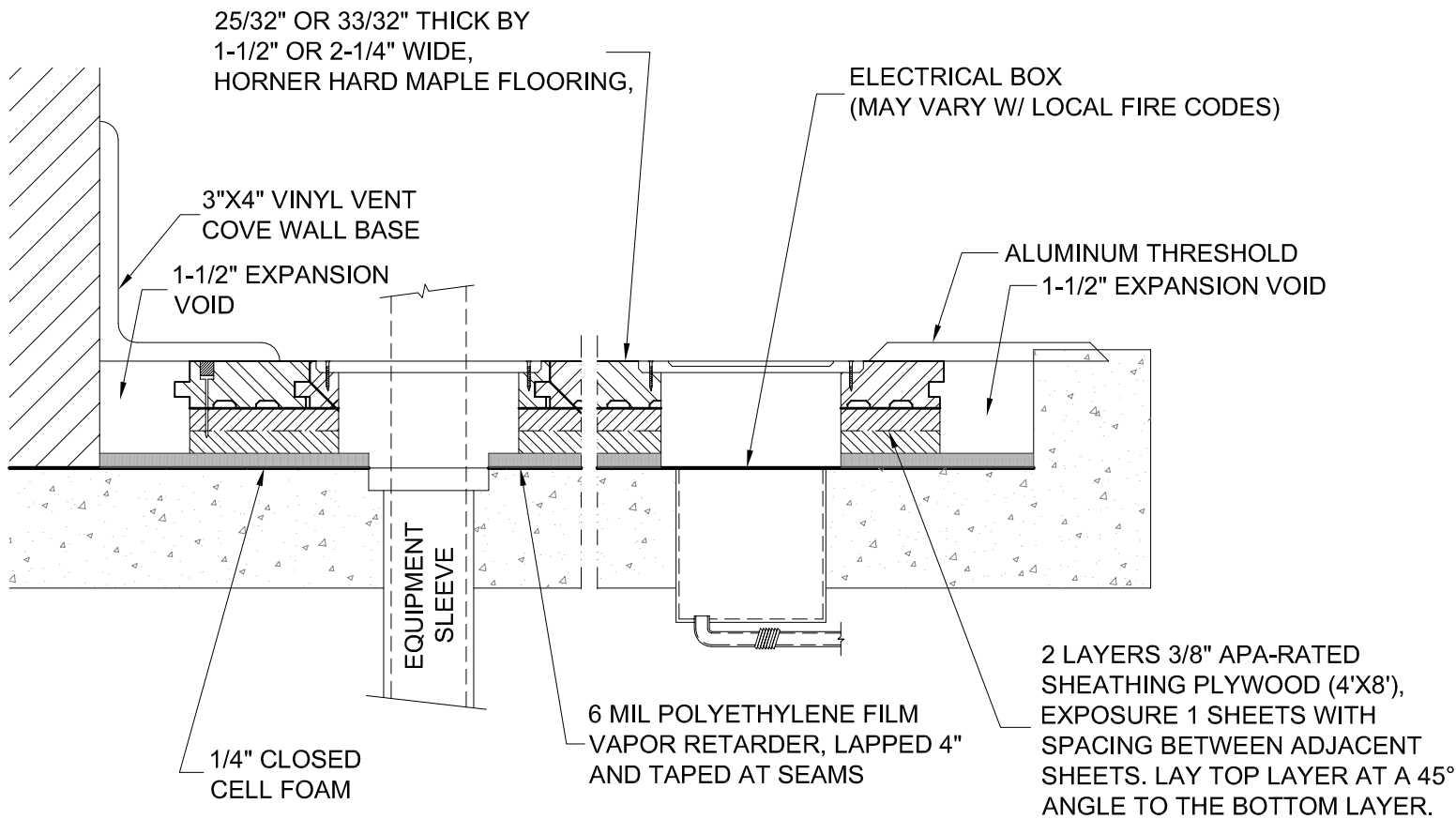

BALANCED PERFORMANCE SYSTEM (BPS) LOW PROFILE

HORNER FLOORING COMPANY
DOLLAR BAY, MI
3-25-11

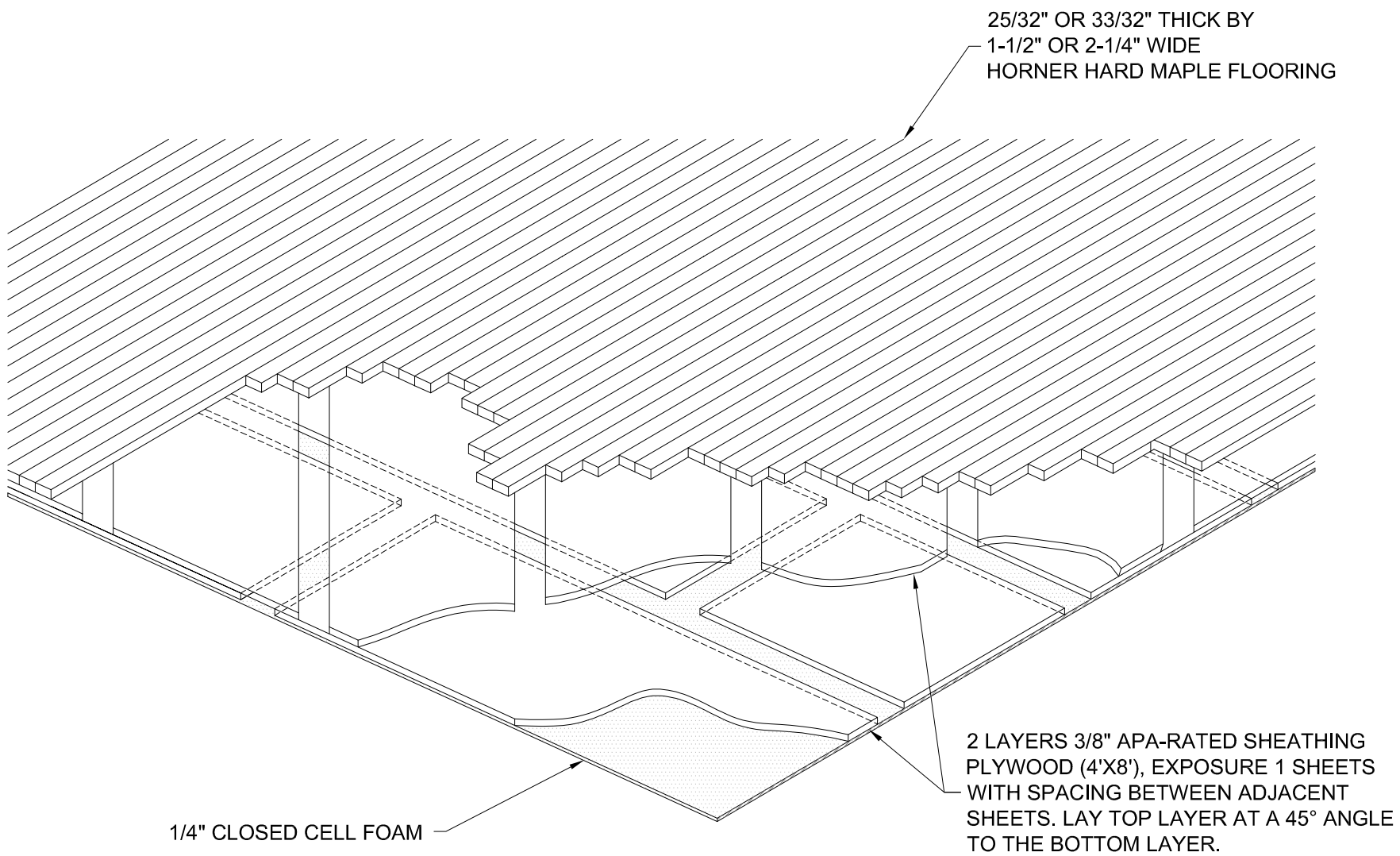

BALANCED PERFORMANCE SYSTEM (BPS) LOW PROFILE

HORNER FLOORING COMPANY
DOLLAR BAY, MI
3-25-11